



DESCRIPTION

The Sola series is a perfect solution two in one solar panel integrated with both durable LiFePO4 battery with 2000 lifecycles, safe & reliable along with LED chip all together in one unique design that delivers unrivaled performances in every environment, optimizing solar energy collection in any condition. Highly efficient with 180-200 Lm/w. Thanks to the smooth surface design, it reduces debris & self-clean under any weather



LED Chip



Illumination Data

Color temperature:	3000K 4000K 5700K 6500K
Lumen output:	3600 LM 5400LM 7200LM 9000LM 10800 LM 14400LM 16200LM
CRI	70
Beam angle	Type II S Type II M Type III M

Physical Specification

Material Finish	Die cast aluminium
Diffuser	Poly carbonate
Optics	LENS
Ingress protection (IP)	66
Impact Protection (IK)	08

Electric Characteristics

Light source	LED Built in
LED type	SMD
Power	20 Watt 30 Watt 40 Watt 50Watt 60 Watt 80 Watt 90 Watt
P.F	>0.9
LED chip	Lumileds
Battery	Lifepo4

Installation

Installation	Post top
Wiring	Product complete with electronic components

Luminaire Body Finish Color

Black Ral 9005	
Grey Ral 9006	

Certificate & Warranty

Certification	CB CE LM79 LM80 TM21 Photo biological
Lifetime expectancy	50.000 hrs
Warranty duration	Up to 5 years



Dimensions & Specs

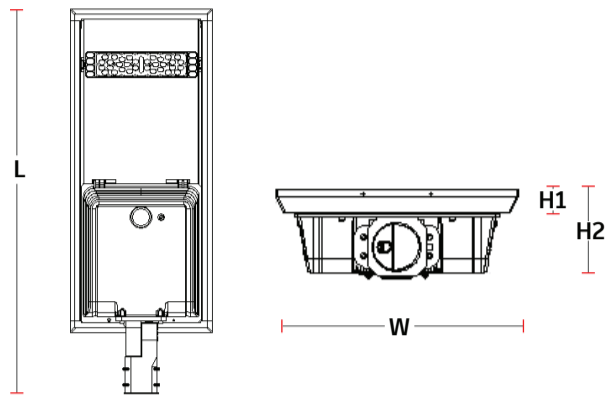

All dimensions in these sketches are in millimeters

Dimnesions & Specs of luminaires

Dim	L	W	H1	H2	Watt	Battery	Lumen
1	543mm	400mm	39mm	138mm	20	12.8V/15AH	3600
2	543mm	400mm	39mm	138mm	30	12.8V/18AH	5400
3	640mm	400mm	39mm	138mm	40	12.8V/24AH	7200
4	914mm	400mm	39mm	138mm	50	25.6V/15AH	9000
5	1051mm	400mm	39mm	138mm	60	25.6V/18AH	10800
6	1246mm	400mm	39mm	138mm	80	25.6V/24AH	14400
7	1538mm	400mm	39mm	138mm	90	25.6V/30AH	16200

All dimensions in this schedule table are in millimeters

Product coding system

BR - SO X P XX.7 XX X 66 X - L

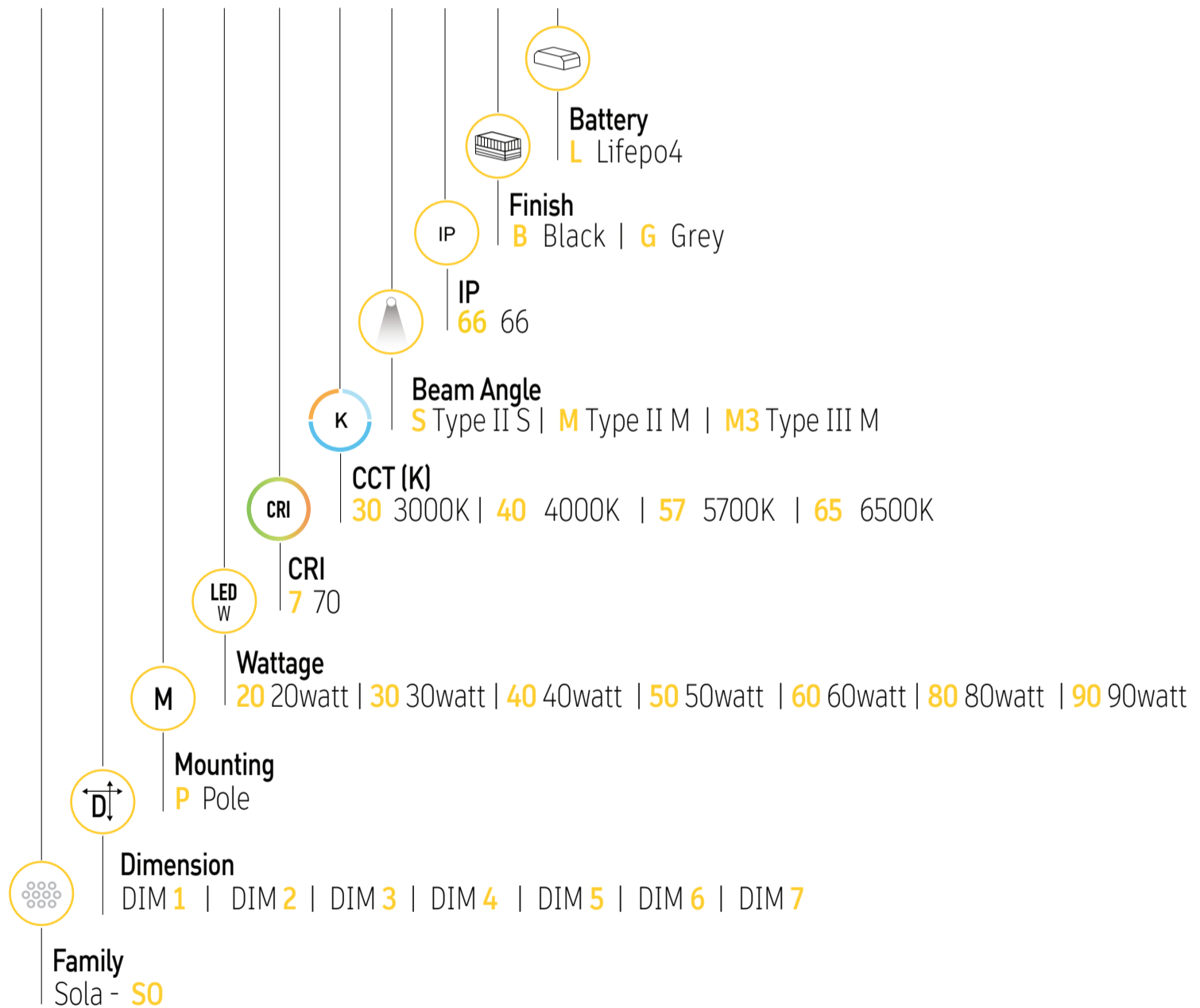

BR - SO X P XX.7 XX X 66 X - L

Configure luminaire specs & send us the code for order confirmation



Optional Application

Brighton luminaires Map

- Brighton Luminaires Range
- Selected Luminaire Default placement

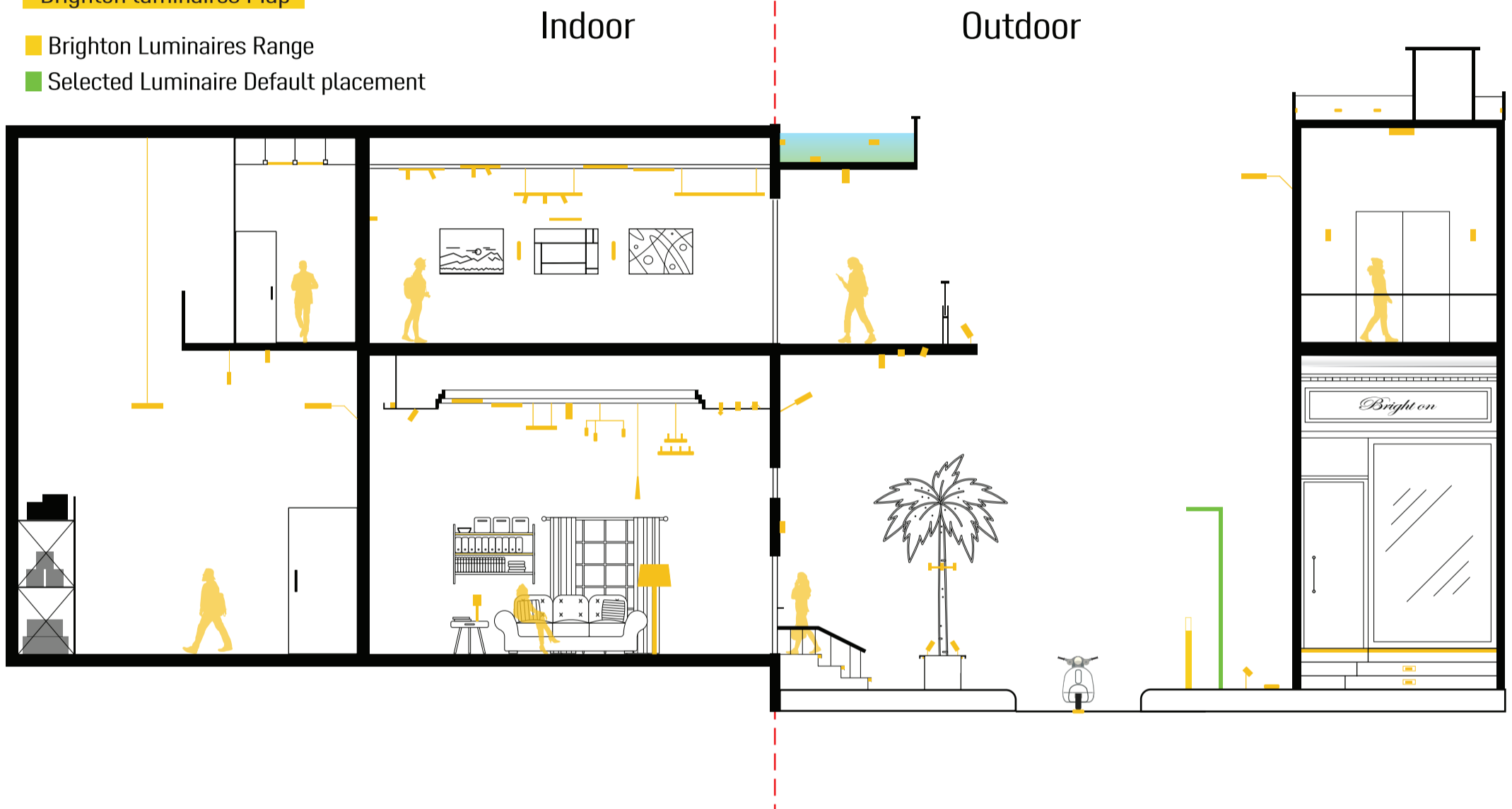

Accessories



Type II S
Polar curve

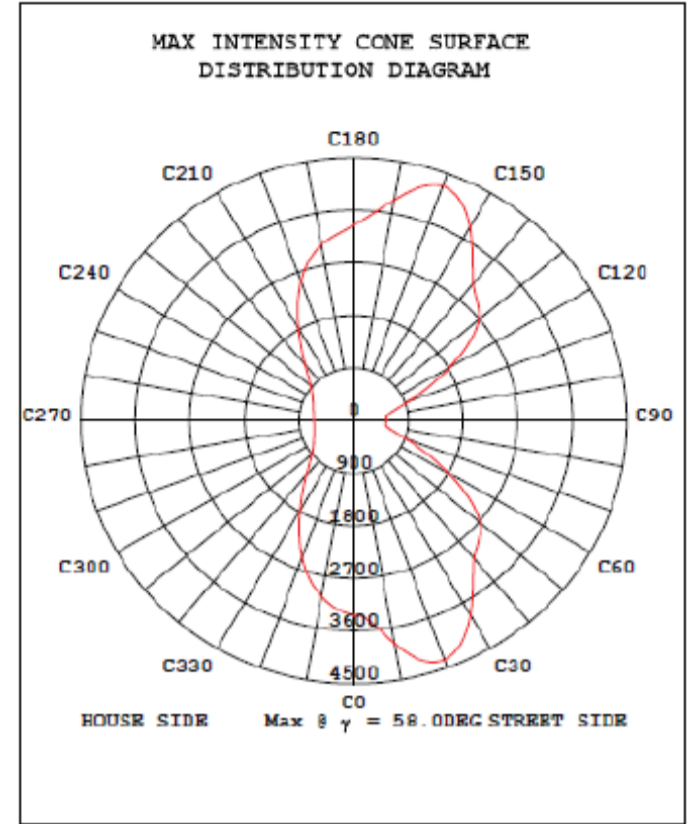
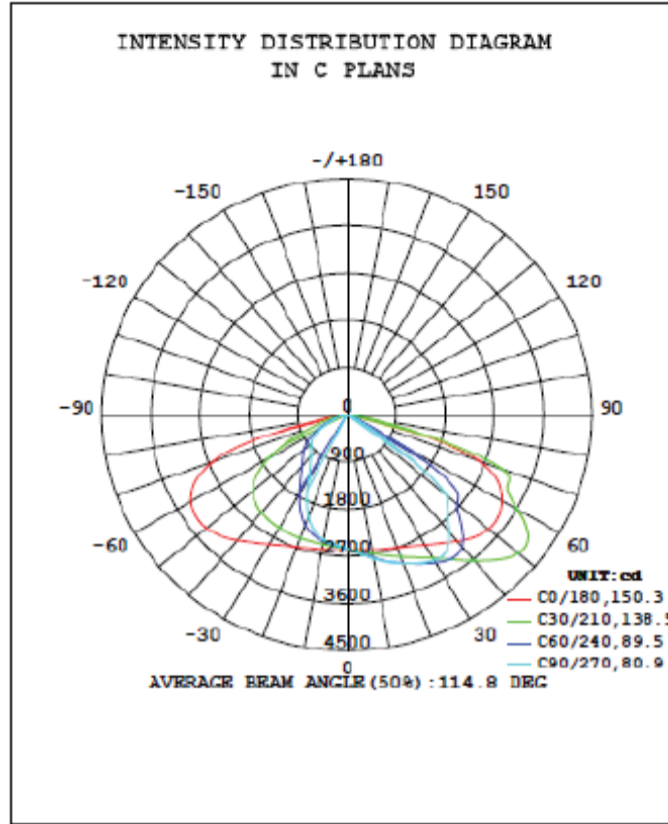

Type II M
Polar curve

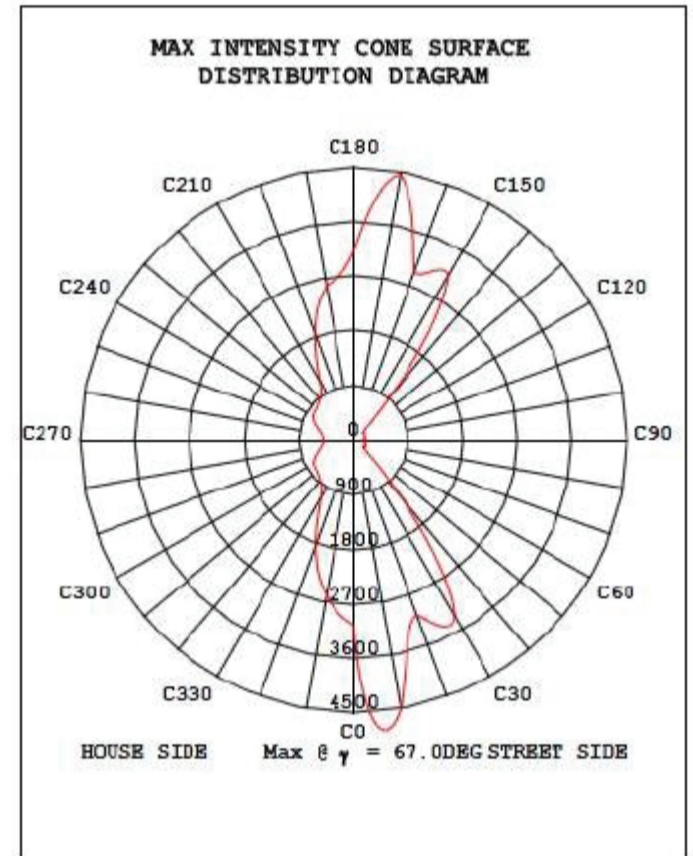
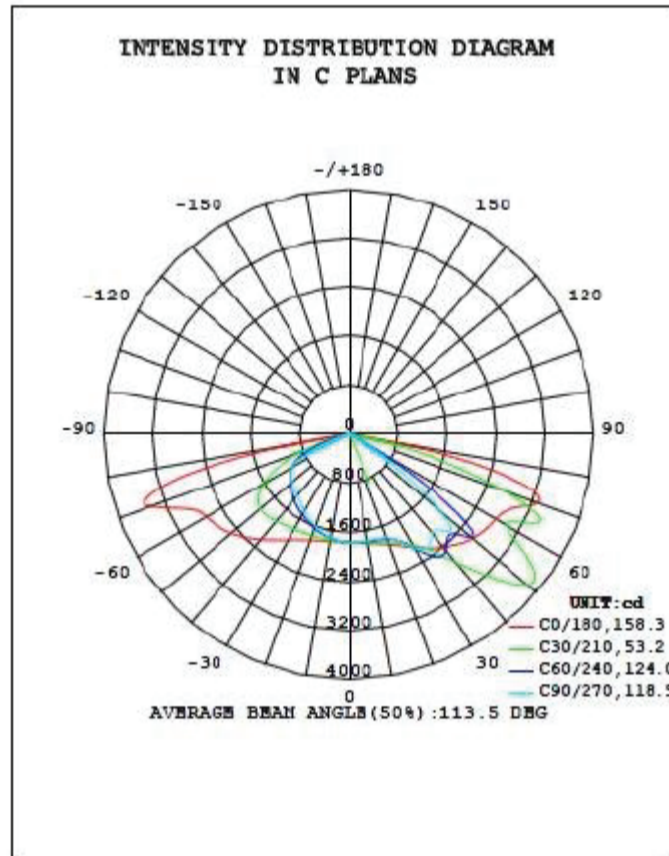

Type III M
Polar curve

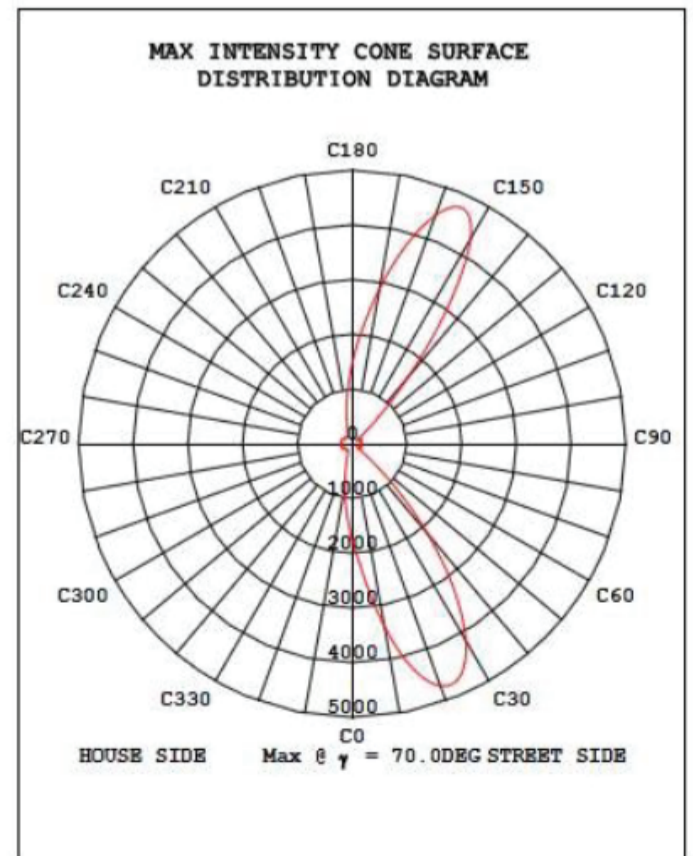
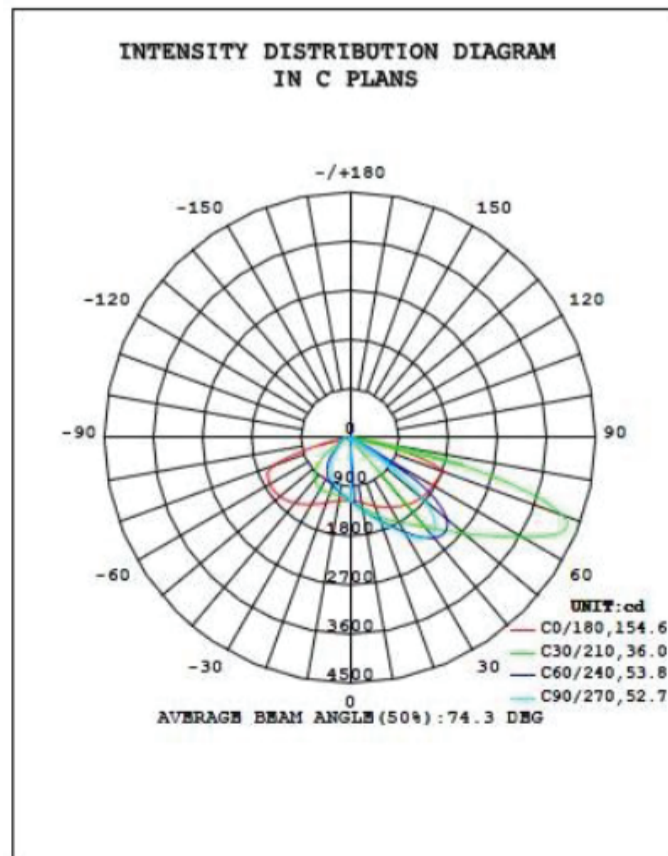



Sola S0

BRIGHTON

